

97xx Vehicle Cradle Converter Kit >

Quick Start Guide

>>

Open Your Box

EN

Assembly

EN

- ✓ Power Converter with Cables Integrated
- ✓ Fuse Holder
- ✓ Fuse
- ✓ Ferrites EMI Core
- ✓ Quick Start Guide

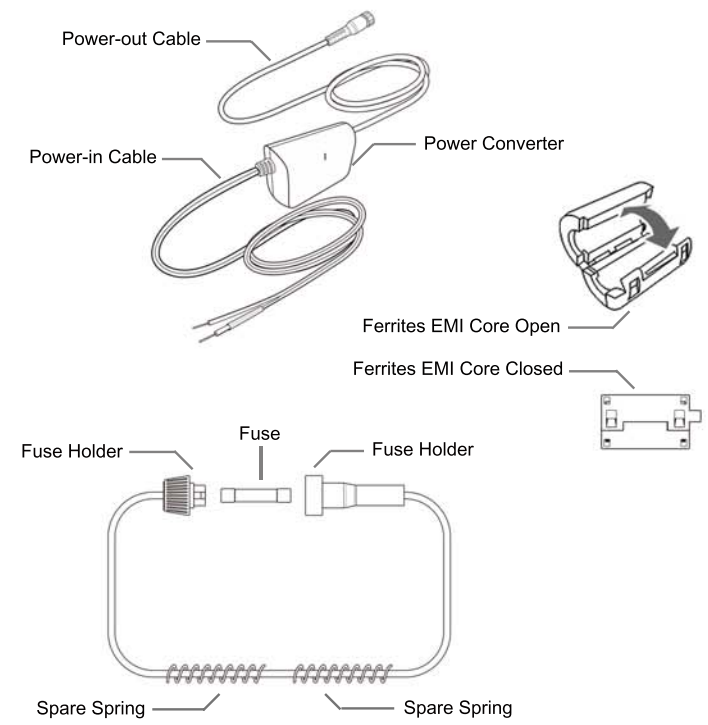

Important Charging Information	
Power Supply	Input: DC 12-24V; Output: DC 5V/3A, CipherLab approved
Power-in Cable	Length: 3m
Power-out Cable	Length: 1.8m

Step 1: Join the two parts of a fuse holder.
Cut the fuse holder wire in half and connect its one end to the positive wire of the power-in cable.

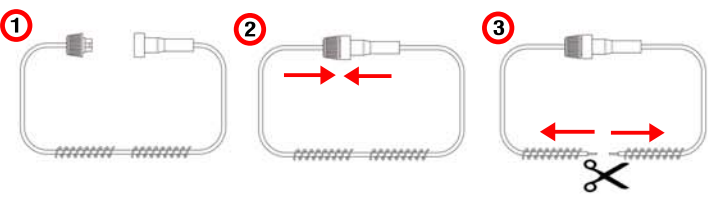

Note: The positive wire(+) comes with a piece of red heat shrink tube and with white print on its black plastic cover.

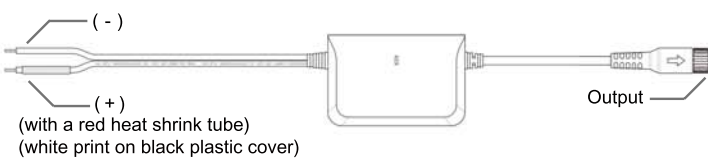

Step 2: Clip the Ferrites EMI Core around the Power-in Cable.

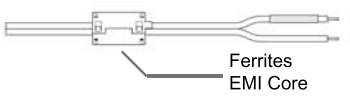

- Step 3: Connect the other end of the fuse holder wire to the positive terminal of a car battery.
- Step 4: Connect the negative wire of the Power-in Cable to the negative terminal of a car battery.
- Step 5: Connect the output to a 97xx Vehicle Cradle.
- Step 6: Secure the converter and cables in the cab of a forklift with cable ties onto such as a rail.

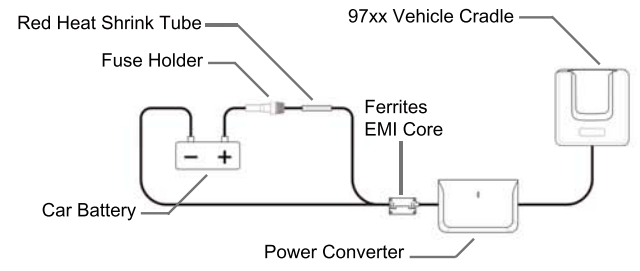

Note: The distance between a car battery and Ferrites EMI Core must be within 15~25 cm.

Note & Warning

1. This power converter is not applicable to all electric forklifts.
2. This power converter supports DC 12-24V power source only.
3. Do not expose the cables to hot surface or sharp objects.
4. Do not place the cables outside of the cab of a forklift.
5. Do not pile things up around the cables. Ensure that there is sufficient space.
6. Do not bend the cables. Ensure that cable turns are as wide as possible.
7. Ensure that all broken wires are insulated from each other.

Recommendation

1. We suggest that the wires of the fuse holder and the Positive Pole be soldered together.
2. Based on the proper length you need, you may shorten the Power-in Cable. Then connect the Positive Pole to the fuse holder by soldering the wires together as recommended.

